

Modular system with covers in stainless steel AISI 304

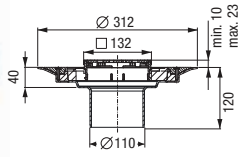
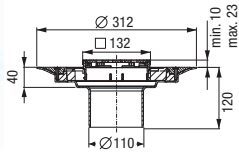

in ABS, incl. mesh fabric

with design cover **Kessel** □ 120 mm
and rim in stainless steel AISI 304, class L 15.
For tile thickness of 8-21 mm, Lock & Lift System
Art. # 47904

with design cover **Oval** □ 120 mm
and rim in stainless steel AISI 304, class L 15.
For tile thickness of 8-21 mm, Lock & Lift System
Art. # 47905

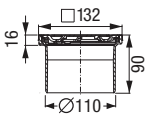

in ABS

design covers □ 120 mm and rim in stainless steel AISI 304, class K 3 / L 15 with or without Lock & Lift System.



	Kessel (Cl. L 15)	Oval (Cl. L 15)	Spot (Cl. K 3)	Cross (Cl. K 3)	Festival (Cl. K 3)	Parade (Cl. K 3)	Slot (Cl. K 3)	Sticks (Cl. K 3)
with Lock & Lift... Art. #	27 201	27 202	27 221	27 213	27 215	27 224	27 219	27 217
without Lock & Lift... Art. #	27 225	27 226	27 220	27 212	27 214	27 223	27 218	27 216

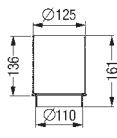

Extension section

in ABS, with lip seal
Art. # 27 146

Multistop

odour, foam, rodent
and insect stop
Art. # 43 500

Transition section

with sealing ring Ø 50
Ø 50/75 Art. # 27 126
Ø 50/40 Art. # 27 118

Conversion kit, "DIN push-fit connection"

for article numbers: 37 3001
Consist of
3 inlet adapter Ø 50 mm,
1 outlet adapter Ø 75 mm
and 1 push-fit connection
for upper section Ø 110,
EN 1451-1
Art. # 37 3008

Conversion kit, "DIN glue connection"

for article number: 37 3001
Consist of
3 inlet adapter Ø 50 mm,
and 1 outlet adapter Ø 75,
EN 1451-1
Art. # 37 3007



Sludge trap

made of polymer
Art. # 27 168

Hair filter

made of polymer, Ø 108 mm
Art. # 43 700

0.8 l/sec flow rate *)
Sealing water height 30 mm

*) according to EN 1253 - 20 mm threshold

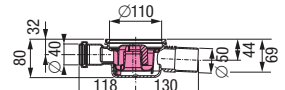
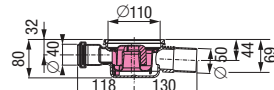
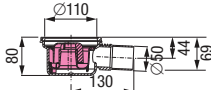

Bathroom drain "The Superflat" in PP

Lateral outlet Ø 50, with removable odour trap

Without lateral inlet

Art. # 42 700

One lateral inlet Ø 40

Art. # 42 701

Three lateral inlets Ø 40

Art. # 42 703