

# Shower channel *Linearis Comfort* System 125

## Shower channel upper section *Linearis Comfort*

1.0 l/sec flow rate  
1.1 l/sec with 10 mm threshold

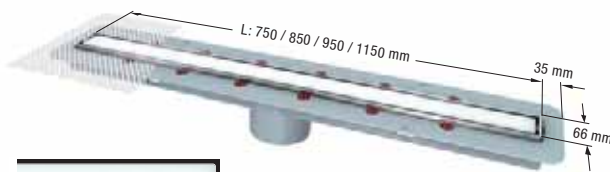

### *Linearis Comfort* in ABS

With removable odour trap, sealing water height 50 mm

- cover and rim in stainless steel AISI 304**  
(Channel cover can be reversed and tiled on site),  
class K 3, with seeping water opening,  
installation supports and mesh fabric

Length	Art. #
750 mm	<b>48 928 S</b>
850 mm	<b>48 929 S</b>
950 mm	<b>48 930 S</b>
1050 mm	<b>48 931 S</b>
1150 mm	<b>48 932 S</b>

### *Linearis Comfort Light* in ABS

With removable odour trap, sealing water height 50 mm

- cover with maintenance-free induction technology and "white" LED lights** (other colours available upon request), 15 m power cable, handles loads up to 100 kg, with seeping water opening, installation supports and mesh fabric

750 mm	<b>48 928 IC</b>
850 mm	<b>48 929 IC</b>
950 mm	<b>48 930 IC</b>
1150 mm	<b>48 932 IC</b>

Minimum installation depth of upper section (without drain body) 46 mm

## Accessories

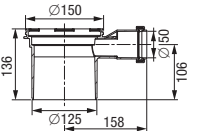
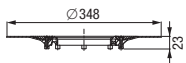

### Glue flange

with counter flange,  $\varnothing$  348 mm  
(also for compound seal)  
Art. # **48 410**

### Pressure sealing flange

in stainless steel AISI 304,  $\varnothing$  273 mm,  
with seeping water opening  
Art. # **48 402**

### Extension section

in PP, with lip seal  
without lateral inlet Art. # **48 987**  
with lateral inlet Art. # **48 989**

## Drain bodies

Total installation height including upper section

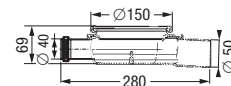
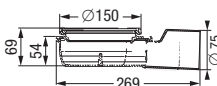
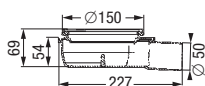
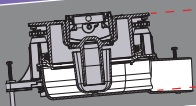

### "The Ultraflat" in ABS

with removable odour trap  
Lateral outlet  $\varnothing$  50  
Art. # **45 700**

Lateral outlet  $\varnothing$  75  
Art. # **45 770**

### "The Ultraflat" in ABS

with removable odour trap  
with lateral inlet  $\varnothing$  40,  
lateral outlet  $\varnothing$  50  
Art. # **45 701**

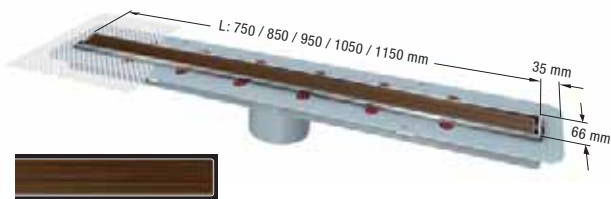

### Linearis Comfort "Wengé" in ABS

With removable odour trap, sealing water height 50 mm

- Cover in wood look,** handles loads up to 100 kg, with seeping water opening, installation supports and mesh fabric

Length	Art. #
750 mm	on request
850 mm	on request
950 mm	on request
1050 mm	on request
1150 mm	on request

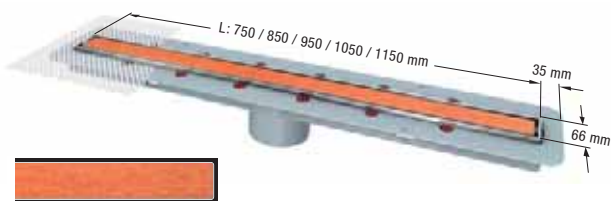

### Linearis Comfort "Burlwood" in ABS

With removable odour trap, sealing water height 50 mm

- Cover in wood look,** handles loads up to 100 kg, with seeping water opening, installation supports and mesh fabric

750 mm	on request
850 mm	on request
950 mm	on request
1050 mm	on request
1150 mm	on request

Minimum installation depth of upper section (without drain body) 46 mm

\* Approval pending on the basis of test certificate no. 210006415 MPA Erwitte.



#### Multistop

odour, foam, rodent and insect stop  
Art. # 48 400

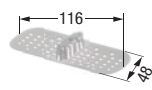

#### Hair filter

made of polymer  
Art. # 48 800



#### Fire-Kit Fire protection insert\*

Only for *Ecoguss/ Practicus* drains with vertical outlet and odour trap

- Ø 58/78/83 Art. # 48 099
- Ø 50/75 Art. # 48 099
- Ø 110 Art. # 48 100



#### Quick-Fit the passage seal

for core drillings for drain bodies with vertical outlet

- without fire protection** Art. # 48 991
- \*with fire protection** Art. # 48 990 (only in combination with *Fire-Kit* protection insert)

The *Linearis Comfort* shower channel inserts already include an odour trap. For this reason, the odour trap must be removed from all drain bodies during installation.



#### Ecoguss

with removable odour trap

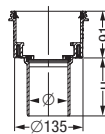
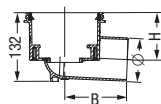

#### Practicus in PP

with removable odour trap



Lateral outlet			Vertical outlet		
Ø	B	H	Article #	H	Article #
58	245	120	48 358	100	48 458
78	134	109	48 378	110	48 478
83	134	108	48 383	110	48 483
110	148	92	48 311	110	48 411

Lateral outlet			Vertical outlet		
Ø	B	H	Article #	H	Article #
50	245	120	45 150	100	45 250
75	134	109	45 170	110	45 270
110	148	92	45 110	110	45 210